



LE PARC DES
EXPOSITIONS
MONTPELLIER

HALL B3



Building surface area
6,000 sqm



Building measurements
L 152.50 x W 40 m



Ceiling height
4.10 to 7.80 m



Uniform load
2,000 kg/m²



Services
4 toilet blocks
2-stream dustbins
Water fountain



Access – Doors

- > Doors / emergency exits H 2.10 m.
- > 1 truck access door:
W 3.90 m – H 4.35 m.
- > 1 truck access door:
W 3.95 m – H 3.95 m.
- > 1 truck access door:
W 4 m – H 4.40 m.



Lighting

- > Lighting using fluorescent lights divided into 4 separate circuits.
- Lighting use invoiced separately.*



Electricity

- > Distribution through ceiling-mounted 160 A power tracks and P17 (32 A) wall sockets.
- > Possibility of having a range of electricity outputs in the hall (on order): from 3 kW single phase to 80 kW three-phase + neutral (i.e. from 16 to 125 amperes).



Sound

- > Speaker system throughout the hall for public address announcements.



Heating

- > Hall heated using hydronic unit heaters – gas boiler. *Heating use invoiced separately.*



Rigging

- > Only lightweight signage can be suspended. Each request for rigging points will be examined in detail by our technical services.



Telephone / Internet

- > Internal phone network (private automatic branch exchange) – dial 0 to phone out.
- > Internet connections possible: wired or Wi-Fi networks.



Water

- > Water supply through floor (trenches, diameter 32) with or without sink (15/21 fitting).

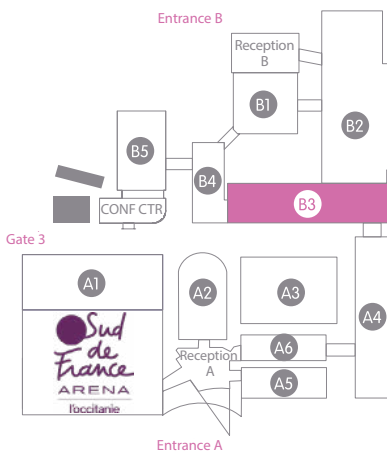

WEST ELEVATION

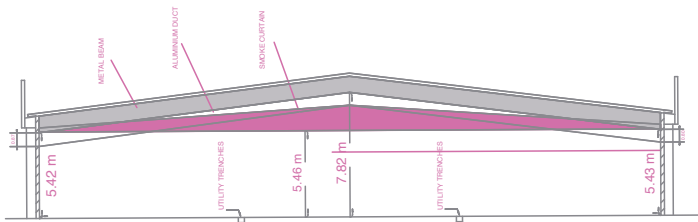

EAST ELEVATION

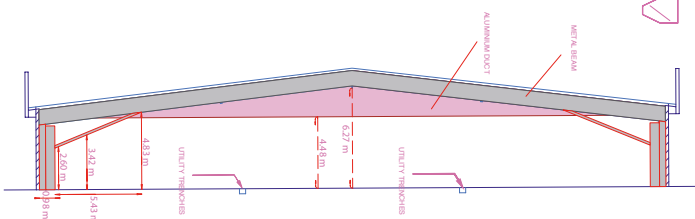

- Truck access
- Extinguisher
- Smoke extraction

