



LE PARC DES
EXPOSITIONS
MONTPELLIER

HALL A1



Building surface area
4,800 sqm
2 fitted changing rooms: 69
sqm
Drug test room: 17 sqm
Capacity: 5,000 pax.



Building measurements
L 110 x W 58 m



Ceiling height
12 to 18.95 m



Uniform load
2,000 kg/m²
Smooth concrete surface



Services
2 toilet blocks
Water fountain
2-stream dustbins



Access – Doors

- > Glazed double doors:
H 2.15 m - W 2.10 m.
- > 1 wide door: H 4.50 m – W 5.25 m.
- > 6 side doors: H 4.50 m – W 4.40 m.



Lighting

- > Lighting using dimmable LEDs.
Lighting use invoiced separately.



Electricity

- > Distribution though ceiling-
mounted 250 A power tracks .



Sound

- > Public address system piped to
reserved area, from reception
zone



Heating

- > Hall heated and airconditioned
using a heat pump. *HVAC use
invoiced separately.*



Rigging

- > Possibility of heavy rigging. Each
request for rigging points will be
examined in detail by our listed
contractors.



Telephone / Internet

- > Internal phone network (private
automatic branch exchange) –
dial 0 to phone out.
- > Internet connections possible:
wired or Wi-Fi networks



Water

- > Water supply through floor
(trenches, diameter 32) with or
without sink (15/21 fitting).

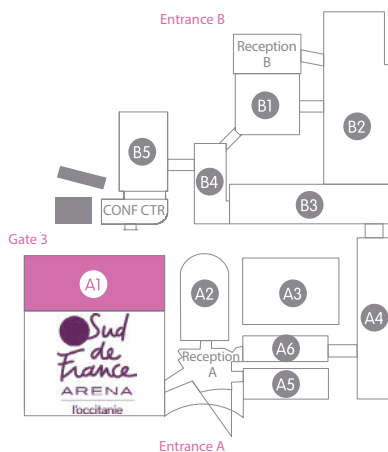

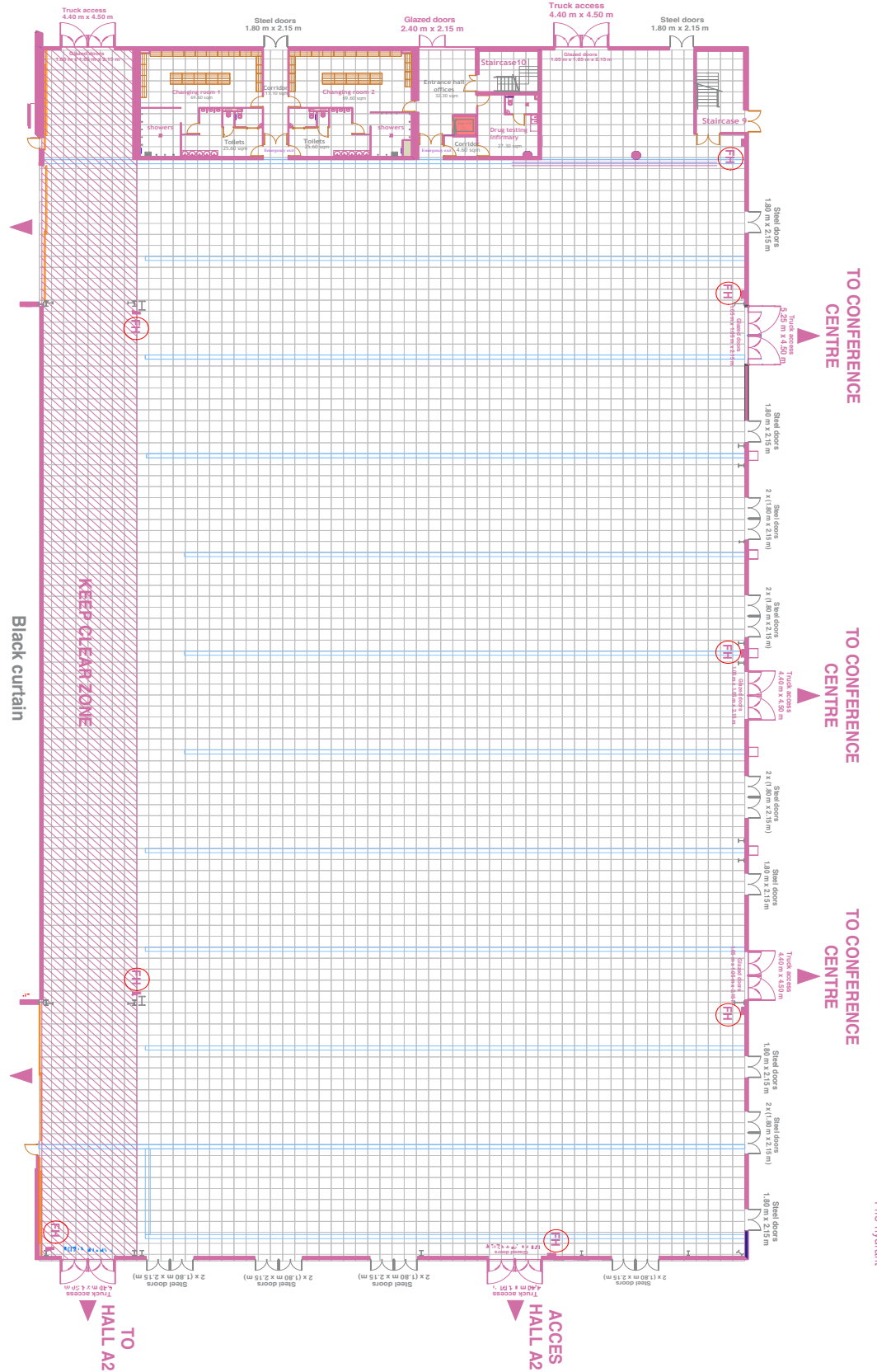
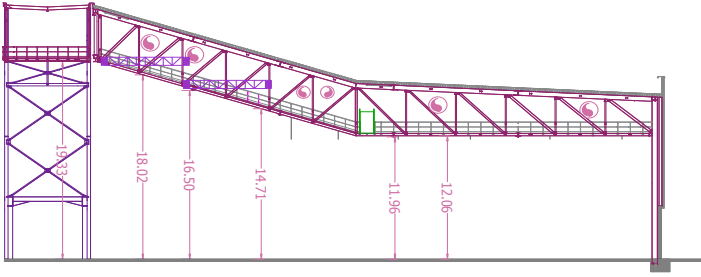

FIRE HYDRANT